

Tana Atkinson 3-5-87



ARCHIVE SERVICES
AURORA PUBLIC LIBRARY AND TELEVISION SERVICES

Administration
14949 East Alameda Drive
Aurora, Colorado 80012
303/695-7450

CERTIFICATE OF AUTHENTICITY

I hereby certify that the microphotographs reproduced on this film are true copies of the original records and in fulfillment of the provisions of Section 24-80-107, Colorado Revised Statutes 1973, as Amended. The records reproduced on this microfilm were created during the normal course of official business of the City of Aurora, Colorado. The description and methods of arrangements and dating of the original records have been retained.

The microfilm images appearing on this film were microfilmed by the Camera Operator indicated, on the date indicated, in the annotation area on the upper left hand side of each imaged frame. Annotations to existing images which would indicate a change of status of the document are authorized by signature of the Records Administrator as indicated on the upper right hand side annotation area of the imaged frame.

July 1, 1985
Date

Sarah M. Colding, CMC
Acting Records Administrator

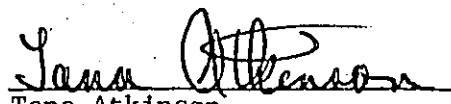
Tana Atkinson
Records & Information Clerk
Camera Operator

Jana Ottumson 3-5-87

CO

1987



CITY OF AURORA, COLORADO
BUILDING INSPECTION
CERTIFICATE OF OCCUPANCY

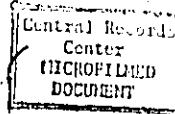

Date 2/27/87

THIS IS TO CERTIFY
THAT THE OFFICE BUILDING

Building Permit No. B76385

Address 15301 East Iliff Avenue

Lot No. 3 Block No. 1 Subdivision Sage East #1

Occupancy Group B-2 Max. Number n/a Use Zone PCZD/COMM

Type Construction VN Contractor HARRY VANDERVLIT

has been inspected and occupancy thereof is hereby authorized.
MAXIMUM ALLOWABLE FLOOR LOAD (LBS. PER SQ. FT.)

Basement lbs. Other 75

Complete Building



Partial Building

Final C.O.



Temporary C.O. Until

19 Pending

TAKE NOTICE

No change shall be made in the use of this building without prior notice and certificate from the Building Official.

ARCHIVES COPY

Do Not Remove From Files

Charles L. McLeod
for Building Official

FORM 620-15

BLDG. INSPECTION FILE COPY

CITY OF AURORA, COLORADO
BUILDING INSPECTION
CERTIFICATE OF OCCUPANCY

Date 8/7/86

THIS IS TO CERTIFY
THAT THE OFFICE BUILDING

Building Permit No. B76385

Address 15301 East Iliff Avenue

Lot No. 3 Block No. 1 Subdivision Sage East #1

Occupancy Group B-2 Max. Number n/a Use Zone PCZD/COMM

Type Construction VN Contractor HARRY VANDERVLIT

has been inspected and occupancy thereof is hereby authorized.
MAXIMUM ALLOWABLE FLOOR LOAD (LBS. PER SQ. FT.)

Basement lbs. Other 75

Complete Building



Partial Building

Final C.O.



Temporary C.O. Until

8/30/86

19 86 Pending

TAKE NOTICE

No change shall be made in the use of this building without prior notice and certificate from the Building Official.

Charles L. McLeod
for Building Official

FORM 620-15

BLDG. INSPECTION FILE COPY

Jana Atkinson 3-5-87

Address 15304 E. ILIFF B 76385
Permit Number B. 15055
Lot 3 Blk. 1 Sub. Div. SAGE EAST #1
Type Const. VA CITY OF AURORA, COLORADO Type of Occ. B-2

ALL GENERAL AND SUB CONTRACTORS ARE REQUIRED TO BE LICENSED

CONTRACTOR

NAME

LIC. NO.

OWNER HARRY VANDERVLIT AO3169
GENERAL
EXCAVATION " " " "
CONCRETE " " " "
CARPENTER " " " "
MASON
ROOFING VALLEY HI ROOFING
LATHING OR GYPSUM-BOARD VANDER VLIT AO3169
HEATING TOPS HEATING + AIR CONDITIONING AO5647
ELECTRICAL SPENCER + BRADLEY AO0524
PLUMBING ARGO PLBB. AO5253
DRAIN LAYING
INSULATION R+G. INSULATION
WATERPROFFING
REFRIGERATION TOPS HEATING + AIR CONDITIONING AO5647
PUBLIC IMPROVEMENTS
Water Meter # 85321032 3/28/86

ROUGH INSPECTION MUST SHOW ON PLUMBING, ELECTRICAL, AND HEATING BEFORE FRAME INSPECTION.

INSPECTION REPORT

DATE

INSPECTOR

PRECONSTRUCTION INSPECTION
FOOTING OR CAISSON 4/2/86 3/3/86
CONCRETE REINFORCING APPROVED 3/3/86 TJNY
FOUNDATION AND WATERPROOFING
ROUGH PLUMBING 3-28-86 6-11-86 MS
GAS PIPE 3-28-86
ROUGH HEATING INSPECTION
ROUGH ELECTRICAL INSPECTION UG. SCHE CONDENS 4-16-86 6/20/86 TJNY
ROUGH FRAME 6/28/86 7-23-86 TJNY
LATH/GYPBOARD 6/28/86 7-23-86 TJNY
FINAL PLUMBING INSPECTION 7-24-86 7-23-86 TJNY
FINAL HEATING/REFRIGERATION
FINAL ELECTRICAL INSPECTION 7-25-86 7-23-86 TJNY
FIRE PROTECTION 7-28-86 7-23-86 TJNY
FINAL ENGINEERING 7-30-86 7-23-86 TJNY
FINAL FRAME APPROVAL 7-30-86 7-23-86 TJNY
FINAL GRADE 7-30-86 7-23-86 TJNY
ZONING 7-30-86 7-23-86 TJNY

CERTIFICATE OF OCCUPANCY MUST BE SECURED BEFORE STRUCTURE IS OCCUPIED.

Jana Ottenson 3-5-87

- 5/5/86 Floor & Roof Insulating Milling (Tony)
5/16/86 Ducting Insulating
5/23/86 Duct Insulating
5-27-86 - ELEC. ROUGH 1ST & 2ND FLR PERIMETER WALLS ONLY JHP
6-5-86 ELEC. ROUGH INTERIOR WALLS; BATHROOMS AND CORRIDORS
1ST & 2ND FLRS EAST END. JHP
6/13/86 Partial R/F Rock Tony
6/14/86 All R/F except offices OK -
Partial Rock Tony
6-16-86 R/H OK, Bathroom 1ST & 2ND floor only MW
2ND floor shaft
6-17-86 ELEC. ROUGH INTERIOR WALLS 2ND FLR, BATHROOM 1ST
& 2ND FLRS. JHP
6-20-86 ELEC. ROUGH INTERIOR WALLS 1ST FLR. JHP
6/25/86 All Rock except one lower bath stair shaft & lobby Tony
6-23-86 ELEC. U.G. SITE LIGHTS JHP
6-26-86 ELEC. U.G. SERVICE RELEASE JHP
7-16-86 ELEC. 'F' CEILINGS 1ST & 2ND FLOORS EXCLUDING CORRIDOR
'CELLING BY MAIN ENTRY + STAIRS' JHP
7-17-86 ELEC. 'R' F FOR ENTRY CEILINGS JHP
7-18-86 ELEC. R/F STAIR WELL CEILINGS JHP

BUILDING INSPECTION

CITY OF AURORA

1470 S. Havana Street

695-7420

INSPECTOR CALLED AT 10:44 A.M. ON 7-23-86

TO INSPECT FINAL Pkg - OK

No one was home, will you kindly notify this office when
inspection can be made.

RJC
Inspector

1986

INSPECTOR'S COPY

Jana Ottenson 3-5-87

2/2/86 Initial Pads w/ steel - All Perimeter Pads OK Tony
3/3/86 Pads & All Steel Tony

Jana Ottenson 3-5-87

1

BUILDING INSPECTION DIVISION
CITY OF AURORA, COLORADO

ADDRESS OF JOB		DATE		BUILDING PERMIT		1	
15301 E. Cliff Ave.		2/12/86					
LEGAL DESCRIPTION		LOT	BLOCK	ADDITION			
		3	1	Super Erector Sub 1			
OWNER NAME		ADDRESS		PHONE			
Moore Co.		390 Grant					
CONTRACTOR	NAME		LICENSE NO.				
	Harry Anderson/Butt Co.		A03169				
	ADDRESS		STREET		CITY	STATE	ZIP
5065 E. Cliff Ave. Denver, Colo. 80222							
SUPERVISOR FOR THIS JOB		NAME					
Simon							
PROPOSED USE OF STRUCTURE (Single Family, Apartment, Restaurant, Office Bldg., Industrial Bldg., Tenant Finish) Office Bldg.							
CLASS OF WORK: NEW <input checked="" type="checkbox"/> ADDITION <input type="checkbox"/> ALTERATION <input type="checkbox"/> REPAIR <input type="checkbox"/> MOVE <input type="checkbox"/> REMOVE <input type="checkbox"/>							
AREA		HEIGHT	NO. OF	TOTAL	OCCUPANCY	USE	
AT GRADE (SF) 4960		(FEET)	STORIES 2	UNITS	GROUP & DIV. B-2	ZONE PC 30-6000	
FINISHED <input type="checkbox"/>		GARAGE SINGLE <input type="checkbox"/>	ATTACHED <input type="checkbox"/>	FIREPLACE YES <input type="checkbox"/>	TYPE		
BASEMENT <input type="checkbox"/> UNFINISHED <input type="checkbox"/>		DOUBLE <input type="checkbox"/>	DETACHED <input type="checkbox"/>	NO <input type="checkbox"/>	CONSTR. VN	84-6045	
IF PLANS ARE SUBMITTED DO NOT WRITE BELOW THIS LINE							
FOUNDATION	DEPTH BELOW GRADE	JOISTS	SIZE AND SPACING		SPAN		
	FOOTING		FLOOR				
	SIZE		CEILING				
	FDN WALL THICKNESS		ROOF				
	CAISSON		RAFTER				
SIZE		GRADE OF LUMBER					
EXT. WALL	MASONRY THICKNESS	FINISH		BRICK <input type="checkbox"/> OTHER <input type="checkbox"/>			
	STUD SIZE & SPACING	FINISH		BLOCK <input type="checkbox"/> SPECIFY			
POST & BEAM	POST SIZE	SPACING		BEAM SIZE			
ROOF	ROOF SHEETING TYPE & SIZE	ROOFING MATERIAL					
REMARKS - FOUNDATION TAXES Paid on Found. Permit B-75055 on 2-12-86 All							
Foundation cost was 22000							
Finished Floor EL. must match approved Civil plans							
8-5-C							
CITY SALES AND USE TAX 3%							
VALUATION OF WORK X 50% X 3% PAID							
NOTES TO APPLICANT:							
FOR INSPECTIONS OR INFORMATION CALL 695-7420.							
TO ASSURE NEXT DAY INSPECTIONS PLEASE CALL BEFORE 4:00PM.							
FOR ALL WORK DONE UNDER THIS PERMIT THE PERMITTEE ACCEPTS FULL RESPONSIBILITY FOR COMPLIANCE WITH THE							
UNIFORM BUILDING CODE AND ALL OTHER APPLICABLE AURORA ORDINANCES.							
REQUIRED INSPECTIONS SHALL BE REQUESTED ONE WORKING DAY IN ADVANCE.							
DO NOT EMPLOY UNLICENSED CONTRACTORS							
THIS BUILDING SHALL NOT BE OCCUPIED UNTIL A CERTIFICATE OF OCCUPANCY HAS BEEN ISSUED.							
SIGNATURE OF APPLICANT Harry Anderson/Butt							
CASHIER							
INSPECTOR'S COPY							

AGENCY AUTHORIZED BY DATE

ZONING

ENGINEERING DEPT. 7/2/86 3/18/86

TRAFFIC ENGINEERING

FIRE DEPT.

HEALTH DEPT.

WATER DEPT.

POLICE DEPT.

FORESTRY DEPT.

WASTEWATER DIV.

VALUATION OF WORK \$ 309,000

PERMIT FEE \$ 30.00

PLAN YES ☐ NO ☐

FILED YES ☐ NO ☐

DOUBLE FEE ☐

TAX PAID \$

TOTAL \$ 30,000

PROTECTIVE INSPECTION DIVISION

APPROVED BY DATE 3/18/86

PERMIT NO. B 76385

THIS FORM IS A PERMIT ONLY WHEN VALIDATED HERE

Jana Ottenson 3-5-87

5/5/86 Nailing of Floor & Roof Sheeting - Tony
3/22/86 Ceiling on both floors, work

6/6/86 Partial RF & Rock of one room
No Bathrooms } Tony

6/17/86 All RF OK except office
Partial Rock } Tony

6/20/86 RF Tony

6/23/86 Rock OK except Lower Bath Rooms, Lobby &
Stair Shaft Areas. } Tony

6/25/86 Rock Tony

7/28/86 RF Packed Tony

7/30/86 RF Tony

Jana Atkinson 3-5-87

MAY 19 1986

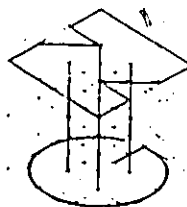

May 15, 1986

COPY

Mr. Bob Snyder
Wagner Architecture Group
777 S. Wadsworth Blvd.
Irongate IV, Suite 212
Lakewood, CO 80226

NEUJAHN
AND
GORMAN
CONSULTING
STRUCTURAL
ENGINEERS
180 COOK STREET
SUITE 305
DENVER, COLORADO
80206
(303) 377-2732

FIELD OBSERVATION: Sage East Office Building
Aurora, Colorado
Job No. 85119

DATE: April 30, 1986

TIME: 2:00 PM

PRESENT: Tom Kingdom, Wayne Braßer

TRIP PURPOSE: Observe Structural Steel Framing

OBSERVATIONS:

1. Structural steel erection appeared to be complete.
2. Floor joists have been installed and decked.
3. Roof joists have been installed and decked with the exception of the area below the mechanical units between grids 5 and 6.
4. Metal cross bracing straps have been installed at grids 1, 5, and 7.
5. The metal stud curtain wall framing was in progress at the time of this visit.
6. Super structure framing appears to be in accordance with the construction documents with the following exceptions:
 - A. The metal cross bracing straps at grid 1 appeared to be loose. These straps must be installed without bows and/or kinks.
 - B. Remaining cross bracing straps must be installed at grids 5 and 6.
 - C. The seismic anchors at the metal stud to second floor connection appeared to be missing nails. Install nails as required.

Sandra Ottinson 3-5-87

Sage East Field Observation
Page 2

- D. Miscellaneous steel "kickers" from wall studs to structure were not in place at the time of this visit. Install at locations shown on the drawings.

Sincerely,

Thomas A. Kingdom

Thomas A. Kingdom, P.E.
Project Engineer

Reviewed by:

Michael J. Gorman

Michael J. Gorman, P.E.
Principal

llh

Jana Ottenson 3-5-87

5

BUILDING INSPECTION DIVISION
CITY OF AURORA, COLORADO

BUILDING PERMIT

ADD OF JO 15301 E Cliff Ave. DATE 3/26/86 COMM. RES. ☒ PLUMBING OR DOMESTIC APPL. ☒ 5

CLASS OF WORK: NEW ☒ ADDITION ☐ ALTERATION ☐ REPAIR ☐ MOVE ☐ WRECK ☐

OWNER

NAME

MOORE AND CO.

ADDRESS

PHONE

778-6600

CONTRACTOR

NAME (AS LICENSED)

ARGO PLUMBING

REGISTRATION NUMBER

AD5753

ADDRESS

3925 W 109th Pl WESTMINSTER CO 80030

PHONE

426-1025

SUPERVISOR

NAME

Terry Stansson

PLUMBING											DOMESTIC APPLIANCES	
FLOOR	BSMT.	1	2	3	4	5	6	7	8	OTHERS	NO. OF UNITS	DESCRIPTION OF WORK
DISH WASHER												
GARB. DISP.												
SINK		1	1									
BATHTUB												
SHOWER												
WASH BOWL		4	2									
WATER CLOSET		3	2									
URINAL		1										
AUTO. WASHER												
WASH TUB												
SINK mop		1	1									
DRINK FOUNTAIN		1										
WATER HEATER			1									
FLOOR DRAIN		2										
SAND TRAP												
UNDERGROUND SPRINKLER SYS.												
TOTAL FIXTURES BY FLOORS		13	7									
TOTAL FIXTURES ON JOB												

CITY SALES AND USE TAX 3%

Material 6500 X 0.3

VALUATION OF WORK X 50% X 3%

NOTE: ALL PURCHASING RECORDS AND INVOICES WILL BE RETAINED FOR A PERIOD OF THREE YEARS.

NOTES TO APPLICANT:

FOR INSPECTIONS OR INFORMATION CALL 695-7420

FOR ALL WORK DONE UNDER THIS PERMIT THE PERMITTEE ACCEPTS FULL RESPONSIBILITY FOR COMPLIANCE WITH THE UNIFORM PLUMBING CODE AND ALL OTHER APPLICABLE AURORA ORDINANCES.

REQUIRED INSPECTIONS SHALL BE REQUESTED ONE WORKING DAY IN ADVANCE. A FINAL INSPECTION SHALL BE MADE BEFORE OCCUPANCY IS PERMITTED.

SIGNATURE OF APPLICANT:

Joseph Ottob.

FORM 620 5

INSPECTOR'S COPY

REMARKS: 5- ROOF DRAWS ON ROOF

VALUATION OF WORK \$ 9,340.00

PLAN YES ☐ NO ☐ PERMIT FEE \$

FILED NO ☐ \$

PENALTY FEE ☐ \$ 117.00

TAX PAID \$ 195.00

TOTAL \$ 312.00

APPROVED BY [Signature] DATE 3/26/86

PERMIT NO.

B 76750

THIS FORM IS A PERMIT ONLY WHEN VALIDATED HERE

CITY OF AURORA
PAID

Jared Atkinson 3-5-87

3-27-86 - ~~SD~~ - OK RJC

6/10/86 R cancelled E

6/11/86 F patch E

6-16-86 - WP, Pe - OK RJC

6-11-86 - WOV - OK E

7-22-86 - F - - NR RJC

7-23-86 - F - - OK RJC

Jana Ottinson 3-5-87

6

BUILDING INSPECTION DIVISION
CITY OF AURORA, COLORADO

BUILDING PERMIT

ADDRESS OF JOB: <u>15301 E. ILLIFF</u>		DATE: <u>3-28-86</u>	COMM. RES. <input checked="" type="checkbox"/>	ELECTRICAL <input type="checkbox"/>	6
CLASS OF WORK: NEW <input checked="" type="checkbox"/> ADDITION <input type="checkbox"/> ALTERATION <input type="checkbox"/> REPAIR <input type="checkbox"/> MOVE <input type="checkbox"/> WRECK <input type="checkbox"/>					
OWNER: NAME <u>Monroe and Co. Realtors</u> ADDRESS <u>370 Grant</u> PHONE _____					
CONTRACTOR	NAME (AS LICENSED) <u>Spunking & Boudin Elec.</u>		REGISTRATION NUMBER <u>A00524</u>		
	ADDRESS <u>700 Maryland St. Denver Co</u>		PHONE <u>595-4650</u>		
	JOURNEYMAN OR RES. WIREMAN FOR THIS JOB		CITY <u>Denver</u> STATE <u>CO</u> ZIP <u>80204</u>		
	NAME <u>Gerald A. Cantrell</u>				

UNIT	DESCRIPTION	UNIT	DESCRIPTION	UNIT	DESCRIPTION
1	SERVICE & EQUIPMENT <input checked="" type="checkbox"/> NEW <input type="checkbox"/> CHGD	42	CIRCUITS	35	FIXTURES
	GARBAGE DISPOSAL	2	FURNACE		RANGE
	DISHWASHER		DRYER		OVENS
2	AIR CONDITIONER		MOTOR <input type="checkbox"/> LESS THAN 1 H.P. NO. <input type="checkbox"/> MORE THAN 1 H.P.		CONSTRUCTION METER

REMARKS: Wire new office building, Contractor Business (permit # B76385)

INSPECTION REPORTS				VALUATION OF WORK \$ <u>20,000</u>	
DATE	ITEM	REMARKS	INSPECTOR	PLAN YES <input type="checkbox"/>	PERMIT FEE
4-16-86	SERVICE U.G.	OK NOTIFIED NO PVC ABOVE GRADE WITH IN BLDG.	JHP	FILED NO <input type="checkbox"/>	\$ <u>164.00</u>
5-27-86	WALLS R	OK PERIMETER WALLS	JHP	PENALTY FEE <input type="checkbox"/>	
6-5-86	R	OK BATH RM. WALLS, FLOOR AND INTERIOR CORRIDOR WALLS EAST HALF	JHP	TAX PAID	\$ <u>360.00</u>
6-17-86	R	OK BATH RM. BATH FLOOR, INTERIOR WALLS 2ND FLOOR	JHP	TOTAL	\$ <u>524.00</u>
6-18-86	SERVICE	POSTED NON CONFORMANCE TO PLANS	JHP	BUILDING INSPECTION APPROVED BY <u>BB</u> DATE <u>3/28/86</u>	

CITY SALES AND USE TAX 3% (OVER)

ESTIMATED VALUE 12,000 360.00

NOTE: ALL PURCHASING RECORDS AND INVOICES WILL BE RETAINED FOR A PERIOD OF THREE YEARS.

NOTES TO APPLICANT:

FOR ALL INSPECTIONS OR INFORMATION CALL 695-7420

TO ASSURE NEXT DAY INSPECTIONS PLEASE CALL BEFORE 4:00 PM

FOR ALL WORK DONE UNDER THIS PERMIT THE PERMITTEE ACCEPTS FULL RESPONSIBILITY FOR COMPLIANCE WITH THE AURORA BUILDING CODE AND ALL OTHER APPLICABLE AURORA ORDINANCES.

REQUIRED INSPECTIONS SHALL BE REQUESTED ONE WORKING DAY IN ADVANCE. A FINAL INSPECTION SHALL BE MADE BEFORE OCCUPANCY IS PERMITTED.

SIGNATURE OF APPLICANT Gerald A. Cantrell

PERMIT AND RECEIPT NO. 1376871

THIS FORM IS A PERMIT ONLY WHEN VALUED HERE

MAR 28 11 25 AM '86

CASHIER
CITY OF AURORA

INSPECTOR'S COPY

Jana Atkinson 3-5-87

- 6.20.86 ELEC. 'R' 1ST FLR - OK INTERIOR WALLS ONLY JAP
6.23.86 ELEC. UG. SITE LIGHTS JAP
6.26.86 ELEC. SERVICE RELEASE JAP
7.16.86 ELEC. 'F' CEILING 1ST + 2ND FLRS EXCLUDING MAIN ENTRY
CORRIDOR + STAIRS JAP
7.17.86 ELEC. R/F ON CORRIDOR CEILING ONLY JAP
7.18.86 ELEC. R/F CEILING ABOVE MAIN STAIRWELL JAP
✓ 7.21.86 ELEC. F - POSTED, NUMEROUS VIOLATIONS JAP
7.25.86 ELEC. FINAL - JAP

Jana Ottenson 3-5-87

15701 E. McPherson

ONE-LINE DIAGRAM RATING

SERVICE TYPE:	PAD MOUNTED TRANSFORMER
SERVICE VOLTAGE:	120/208V, 3P, 4W
AVAILABLE SHORT CIRCUIT CURRENT:	29500 A SYM X/R = 1.00
SYSTEM POWER FACTOR:	.91
SERVICE ENTRANCE FEEDER (SEF): (SEG):	2- 3-4-350-CU-THW 1#2/0 CU TO COLD/WATER PIPE 1#2/0 CU TO BUILDING STEEL
METERING: MT01	WATTHOUR METER WITH CT ONLY

CITY OF AURORA
ELEC. SECTION

Approved as Noted

Date

ITEM DESIGNATION	EQUIPMENT RATINGS	FEEDER N COND W WIRE INSL R SIZE W SIZE TYPE
CB01	600A BUS	2- 3-4-350-CU-THW
ES01	30A SW - 30A FU FRN	3/4-4#8 -CU-THWN
L1E	100A MLO	1/2-4#10 -CU-THWN
MS01	200A SW - 175A FU FRN	2-4#2/0-CU-THW
L1A	225A MLO	2-4#2/0-CU-THW
MS02	60A SW - 60A FU FRN	1 1/4-4#4 -CU-THW
L1M	100A MLO	1 1/4-4#4 -CU-THW
MS03	100A SW - 80A FU FRN	1 1/4-3#3 -CU-THW
Z01		1 1/4-3#3 -CU-THW
MS04	200A SW - 200A FU FRN	
CB01	225A BUS	2-3#3/0-CU-THW
FS02	100A SW - 80A FU FRN	1-3#3 -CU-THW
HVAC2		1-3#3 -CU-THW
FS03	60A SW - 45A FU FRN	3/4-3#6 -CU-THWN
HVAC3		3/4-3#6 -CU-THWN
FS01	100A SW - 80A FU FRN	1-3#3 -CU-THW
HVAC1		1-3#3 -CU-THW



ELECTRICAL CONSULTING ENGINEERS
2040 FEDERAL BLVD.
DENVER, COLORADO 80211 SUITE 203

Project
MODERNA SALES OFFICE AT 2000 EAST

Designer M.M.S.

Date 7/23/86

Drawn C.A.D.

Job No. 05100.01

SK
B2

Jana Atkinson 3-5-87

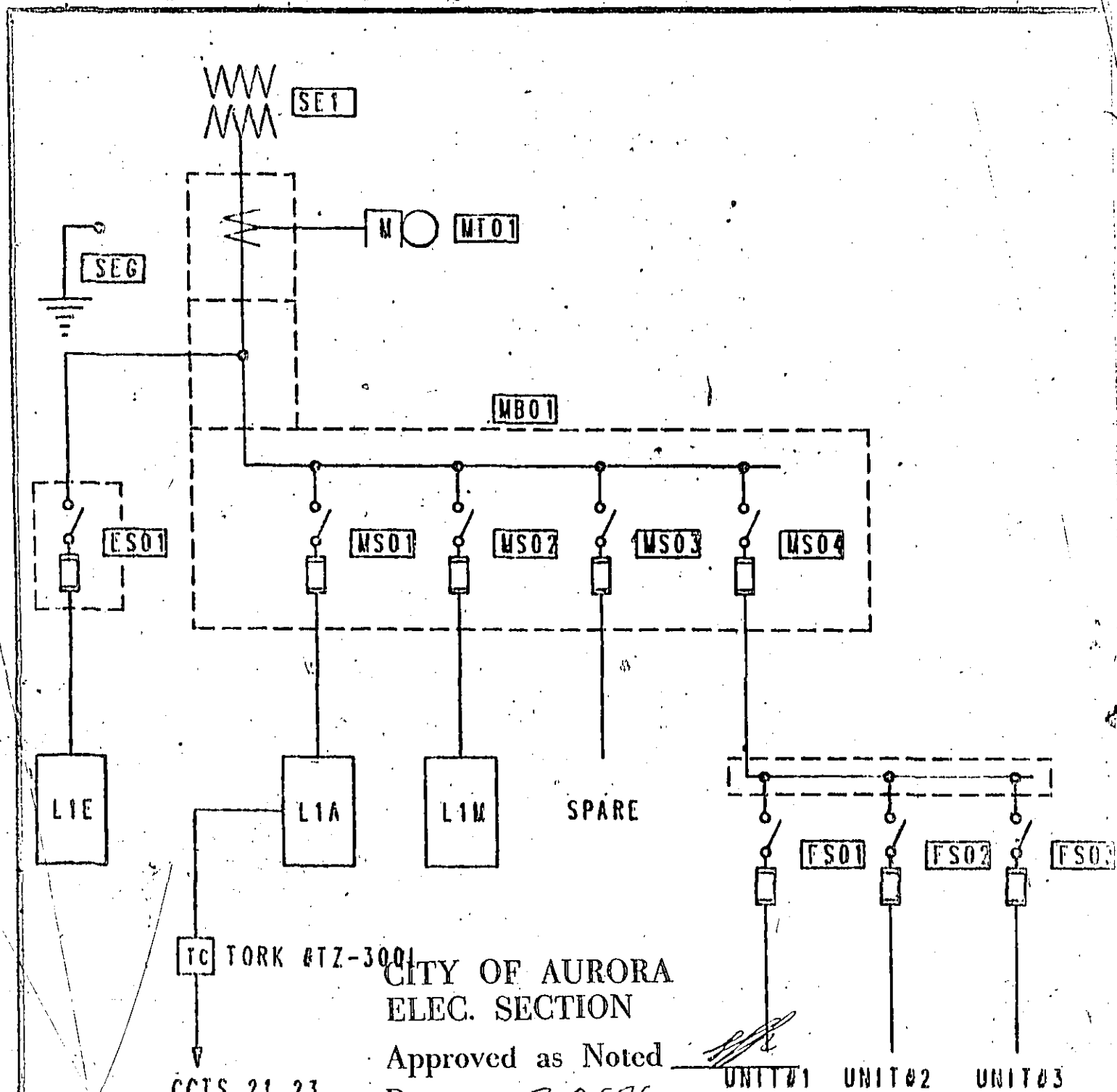

ONE-LINE DIAGRAM
NO SCALE

CAV
& ASSOC.

ELECTRICAL CONSULTING ENGINEERS
2040 FEDERAL BLVD.
DENVER, COLORADO 80201 SUITE 200

Project

MOSES SALES OFFICE AT SAGE FAIR

Designer RMS.

Date 7/25/86

Drawn C.A.D.

Job No. CCTS.01

Jana Ottenson 3-5-87

7

BUILDING INSPECTION DIVISION
CITY OF AURORA, COLORADO

BUILDING PERMIT

ADDRESS OF JOB	15301 E 1st Ave	DATE	5-12-86	COMM. RES.	<input checked="" type="checkbox"/>	WARM AIR HTG. VENTILATION AIR CONDITIONING PERMIT	7
----------------	-----------------	------	---------	------------	-------------------------------------	---	---

OWNER	NAME	Brauer-Vander Vliet Const.	ADDRESS		PHONE	
-------	------	----------------------------	---------	--	-------	--

CONTRACTOR	NAME	Tops Heating & Air Cond Co		LICENSE NO.	A0 5647	
	ADDRESS	2412 S Leyden	Dover Co	80222	PHONE	733-7586
	SUPERVISOR OF JOB	NAME	Don Top			

CLASS OF WORK:	NEW <input checked="" type="checkbox"/>	ADDITION <input type="checkbox"/>	ALTERATION <input type="checkbox"/>	REPLACE <input type="checkbox"/>
BTU RATING	630 ⁰⁰		TYPE OF CONSTRUCTION (IF COMMERCIAL)	PLAN REVISION & PERMIT

NO. OF UNITS	DESCRIPTION OF WORK	NO. OF UNITS	DESCRIPTION OF WORK
3	FORCED AIR HEATING SYSTEM		AIR CONDITIONING SYSTEM
	MAKE-UP AIR SYSTEM		EVAPORATIVE COOLING
	HOT WATER HEATING SYSTEM		GAS PIPING
	STEAM HEATING SYSTEM		REFRIGERATION
	RANGE/GREASE HOOD/EXHAUST SYSTEM	3	ROOF TOP UNITS

REMARKS:	VALUATION OF WORK
Includes Plan Check Charge	\$ 30,750 ⁰⁰
Plan Check \$30.00	PERMIT FEE
	\$ 29.00
	PENALTY FEE <input type="checkbox"/>
	\$ 30.00
	TAX PAID
	\$ 336.00
	TOTAL
	\$ 657.00
	BUILDING INSPECTION
	APPROVED BY
	DATE
	PERMIT NO.
	B 79331
CITY SALES AND USE TAX 3%	
ESTIMATED VALUE	
Materials 11200 ⁰⁰	
x 3% 336 ⁰⁰	

INSPECTION REPORTS			
Date	Item	Remarks	Inspector
6-10-86	gas pipe	ported not at 20/10s	MW
6-11-86	gas pipe		MW
6-12-86	rough	ported	MW
6-16-86	rough (partial) 2nd floor shaft / 1st & 2nd floor bedrooms		MW
7-16-86	FINED	(CONVICTION) - TO ERRC FOR FINED	PER
		ROUGH NOT READY (PVC UNPROTECTED. SHIRT WIRE	
		AND SOME RUNS NOT COMPLETE)	

NOTES TO APPLICANT:	THIS FORM
FOR INSPECTIONS OR INFORMATION CALL 695-7420.	ONLY WHEN VALIDATED HERE
TO ASSURE NEXT DAY INSPECTIONS PLEASE CALL BEFORE 4:00 P.M.	
FOR ALL WORK DONE UNDER THIS PERMIT THE PERMITTEE ACCEPTS FULL RESPONSIBILITY FOR COMPLIANCE WITH THE UNIFORM MECHANICAL CODE AND ALL OTHER APPLICABLE AURORA ORDINANCES.	
REQUIRED INSPECTIONS SHALL BE REQUESTED ONE WORKING DAY IN ADVANCE. A FINAL INSPECTION SHALL BE MADE BEFORE OCCUPANCY IS PERMITTED.	
SIGNATURE OF APPLICANT:	
Jay Stop	

FORM 620-7

INSPECTOR'S COPY

Jana Ottinson 3-5-87

7-17-86 - ROUGH - PARTIAL OK

PER

7-22-86 - FINAL - POSTED

PER

7-24-86 - FINAL - OK - PER

Jana Peterson 3-5-87

5

BUILDING INSPECTION DIVISION
CITY OF AURORA, COLORADO

BUILDING PERMIT

ADDRESS OF JOB	15301 E ILIFF AVE SAGE East Shopping Center	DATE	7/14/86	COMM. RES.	<input checked="" type="checkbox"/>	PLUMBING OR DOMESTIC APPL.	<input type="checkbox"/>	5
----------------	--	------	---------	------------	-------------------------------------	----------------------------	--------------------------	---

CLASS OF WORK: NEW ☐ ADDITION ☒ ALTERATION ☐ REPAIR ☐ MOVE ☐ WRECK ☐

OWNER

NAME MOORE Real Estate ADDRESS 390 Grant Denver Co PHONE 778-6600

CONTRACTOR

NAME (AS LICENSED) THE OLIVE TREE REGISTRATION NUMBER AD 9485
ADDRESS 4849 W. Kentucky Ave. Denver Co PHONE 936-2059
STREET CITY STATE ZIP
SUPERVISOR NAME TAM T. JAMES

PLUMBING											
FLOOR	BSMT.	1	2	3	4	5	6	7	8	OTHERS	
DISH WASHER											
GARB. DISP.											
SINK											
BATHTUB											
SHOWER											
WASH BOWL											
WATER CLOSET											
URINAL											
AUTO. WASHER											
WASH. TUB											
SLOP SINK											
DRINK FOUNTAIN											
WATER HEATER											
FLOOR DRAIN											
SAND TRAP											
UNDERGROUND SPRINKLER SYS.											
TOTAL FIXTURES BY FLOORS											
TOTAL FIXTURES ON JOB											

6611

DOMESTIC APPLIANCES

NO. OF UNITS	DESCRIPTION OF WORK
	WATER SOFTENER

REMARKS:

Addition to existing
tap and main line

ROW - 0

VALUATION OF WORK \$ 2,500.00

PLAN YES ☐ NO ☐
FILED YES ☐ NO ☐

PENALTY FEE ☐ \$ 54.00

TAX PAID \$ 21.00

TOTAL \$ 25.00

BUILDING INSPECTION

APPROVED BY [Signature] DATE 7-14-86

PERMIT NO. B-81809

THIS FORM IS A PERMIT
ONLY WHEN VALIDATED HERE

PAID

JUL 14 10 03 AM '86

CASHIER
CITY OF AURORA

CITY SALES AND USE TAX 3%

VALUATION OF WORK 2500 x 3% = 75.00 x 3% = 21.00

NOTE: ALL PURCHASING RECORDS AND INVOICES WILL BE RETAINED FOR A PERIOD OF THREE YEARS.

NOTES TO APPLICANT:

FOR INSPECTIONS OR INFORMATION CALL 695-7420

FOR ALL WORK DONE UNDER THIS PERMIT THE PERMITTEE ACCEPTS FULL RESPONSIBILITY FOR COMPLIANCE WITH THE UNIFORM PLUMBING CODE AND ALL OTHER APPLICABLE AURORA ORDINANCES.

REQUIRED INSPECTIONS SHALL BE REQUESTED ONE WORKING DAY IN ADVANCE. A FINAL INSPECTION SHALL BE MADE BEFORE OCCUPANCY IS PERMITTED.

SIGNATURE OF APPLICANT: [Signature]

FORM 620-5

INSPECTOR'S COPY

Jana Ottenson 3-5-87

7-16-86 > SPK - OF - EUC

Jana Ottenson 3-5-87

3

CITY OF AURORA BUILDING INSPECTION

BUILDING PERMIT

ADDRESS OF JOB 15301 EAST FLIFF AVE		DATE 8-25-86	SIGN INSTALLATION 3
LEGAL DESCRIPTION LOT 3		BLOCK 1	ADDITION SAGE EAST No 1
OWNER NAME MOORE & COMPANY		ADDRESS 390 GRANT ST., DENVER	
CONTRACTOR	NAME SUMMIT SIGN COMPANY		LICENSE NO. AD 4881
	ADDRESS 16000 WEST 5TH AVE, GOLDEN CO 80401		PHONE 753-6580
	SUPERVISOR FOR THIS JOB NAME CHRIS SMITH, 4295 E. MEXICO, #1005 DEN 753-6080		
ELECTRICAL CONTRACTOR NAME ADDRESS			
SEPARATE PERMIT REQUIRED FOR ELECTRICAL SIGNS			
WHEN SIGNED AND VALIDATED BY BUILDING INSPECTION DEPARTMENT THIS PERMIT AUTHORIZES THE WORK DESCRIBED BELOW.			
CLASS OF WORK: NEW <input checked="" type="checkbox"/> ADDITION <input type="checkbox"/> ALTERATION <input type="checkbox"/> REPAIR <input type="checkbox"/> WRECK <input type="checkbox"/>			
APPLICANT TO COMPLETE DATA BELOW - PLOT PLAN & ELEVATION TO BE ATTACHED			
TYPE OF SIGN	FEATURES OF PROPOSED SIGN		EXISTING SIGNS
GROUND SIGN <input type="checkbox"/>	WILL BE ILLUMINATED <input checked="" type="checkbox"/>	YES <input checked="" type="checkbox"/> NO <input type="checkbox"/>	NUMBER OF EXISTING SIGNS 0
ROOF SIGN <input type="checkbox"/>	IF YES, IS LIGHT SOURCE CONCEALED <input checked="" type="checkbox"/>	YES <input checked="" type="checkbox"/> NO <input type="checkbox"/>	TOTAL SQ. FOOTAGE OF EXISTING SIGNS 0
WALL SIGN <input checked="" type="checkbox"/>	U L NUMBER		BUILDING FRONTAGE 103 FEET SOUTH 60' WEST
PROJECTING SIGN <input type="checkbox"/>	NUMBER OF FACES ON SIGN ONE		STREET FRONTAGE FEET 60' NORTH
COMBINATION SIGN <input type="checkbox"/>	TOTAL AREA OF SIGN, ALL SIDES 475 SQ. FT. 30.59		
OTHER <input type="checkbox"/>	TOTAL HEIGHT OF SIGN 3 FEET		
	PROJECTING OVER PUBLIC PROPERTY 0 FEET		
REMARKS: SIGN A		AGENCY AUTH. BY DATE	
		ZONING 2 AUTH. BY 8/25/86	
		TRAFFIC ENGINEERING	
		VALUATION OF WORK \$ 2,980.00	
		PLAN YES <input type="checkbox"/> PERMIT FEE	
		FILED NO <input type="checkbox"/> \$ 12.00	
		PENALTY FEE <input type="checkbox"/> \$ 62.58	
		TAX PAID \$ 74.58	
		TOTAL \$ 74.58	
CITY SALES AND USE TAX 3%		BUILDING INSPECTION	
50% OF ESTIMATED VALUE OF MATERIALS AND LABOR		APPROVED BY 8/25/86	
ESTIMATED VALUE X 50% X 3%		PERMIT AND RECEIPT NO. 286-331	
NOTE: ALL PURCHASING RECORDS AND INVOICES WILL BE RETAINED FOR A PERIOD OF THREE YEARS.		THIS FORM IS A PERMIT ONLY	
NOTES TO APPLICANT:			
FOR INSPECTIONS OR INFORMATION CALL 695-7420			
FOR ALL WORK DONE UNDER THIS PERMIT THE PERMITTEE ACCEPTS FULL RESPONSIBILITY FOR COMPLIANCE WITH THE AURORA CODE.			
INSPECTION MUST BE CALLED UPON COMPLETION OF INSTALLATION.			
ALL RIGHTS AND PRIVILEGES REQUIRED UNDER THE PROVISIONS OF THE CITY SIGN REGULATIONS WHICH PERTAIN TO SIGN PROJECTING OVER PUBLIC PROPERTY ARE HERE LICENSES REVOCABLE AT ANY TIME BY THE CITY COUNCIL.			
* PAYABLE IF WORK IS STARTED BEFORE PERMIT IS REQUESTED.			
SIGNATURE OF APPLICANT			

Jana Ottenson 3-5-87

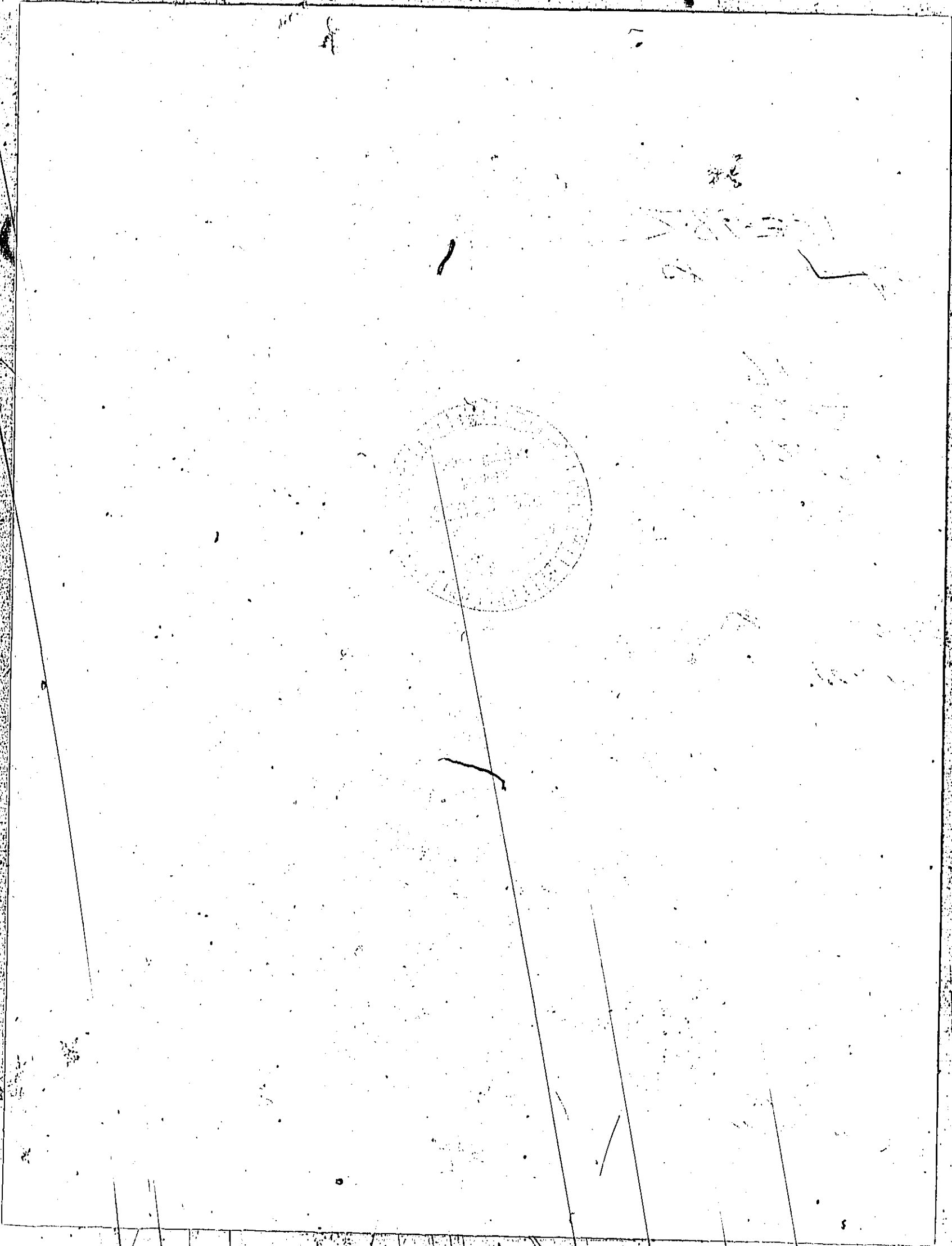

Jana Ottenson 3-5-87

CITY OF AURORA BUILDING INSPECTION DIVISION PLOT PLAN

ADDRESS 15304 EAST ILIFF AVE

LEGAL
DESCRIPTION

LOT 3

BLK 1

SAGE EAST 1
ADDITION No 1

NOTE: INDICATE THE FOLLOWING INFORMATION - STREETS, ALLEYS AND/OR EASEMENTS; FRONT, REAR AND SIDE YARD SETBACKS; DIMENSIONS BETWEEN BUILDINGS AND DIMENSIONS OF BUILDINGS.
INDICATE EXISTING STRUCTURES WITH BROKEN LINE ----- PROPOSED STRUCTURES BY SOLID LINE _____

Sign A

GRAPH SQUARES ARE 5' X 5' OR 1" = 20'



INDICATE NORTH IN CIRCLE

PLOT PLAN

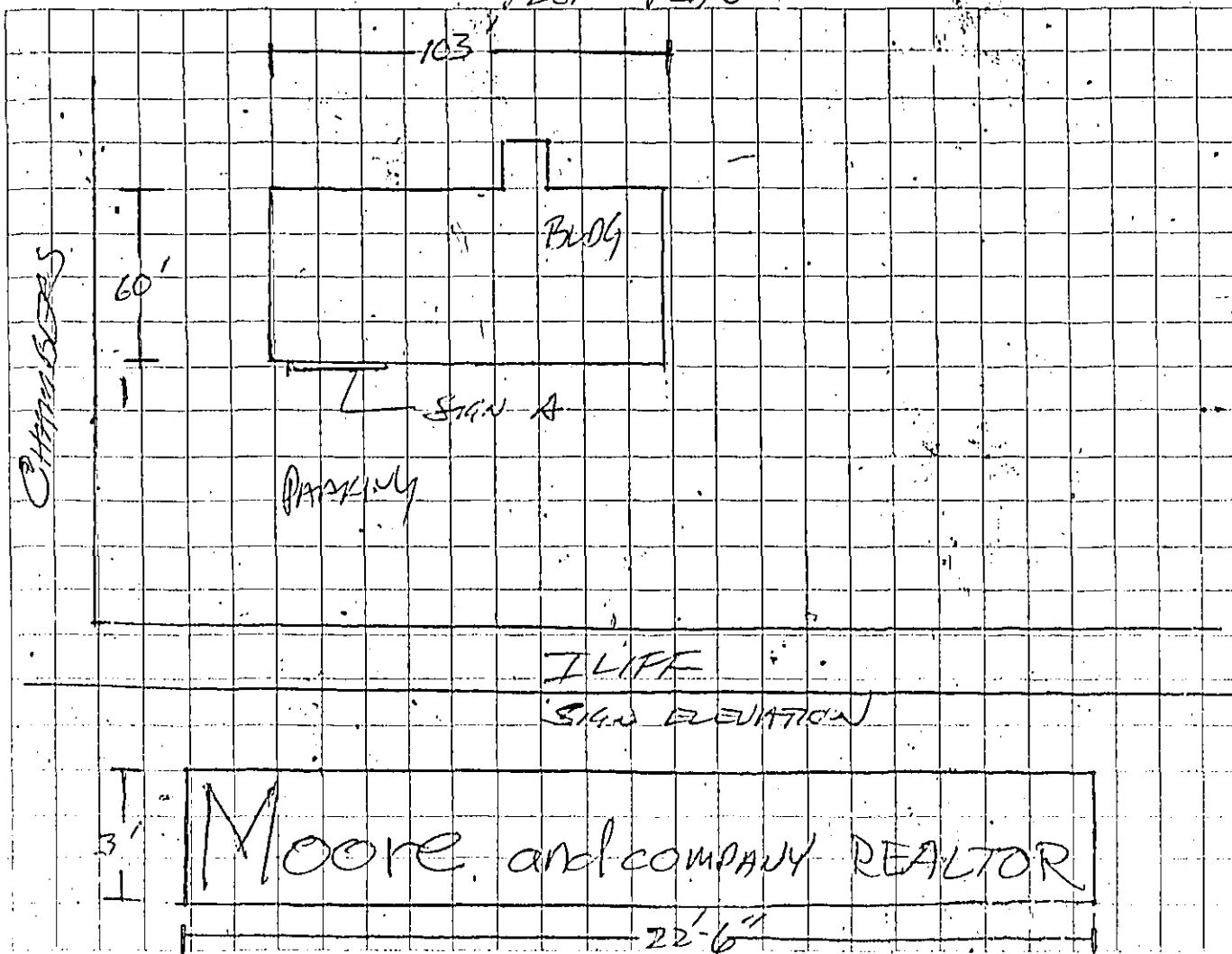

I/We certify that no use will be operated on the land or in the structure (s) identified above except the use (s) set forth above unless a new certificate of occupancy is obtained, the uses will be operated in compliance with the regulations, contained in the zoning chapter of the revised municipal code.

Name(s) of Owner(s) of Site & Structure(s) (Print)

DO NOT WRITE BELOW THIS LINE

Signature of Owner(s) or Authorized Representative

DISTRICT

Common

APPROVED
AS NOTED

[Signature]

DATE

8/25/86

Jana Ottenson 3-5-87

3

130

III

CITY OF AURORA BUILDING INSPECTION

BUILDING PERMIT

ADDRESS OF JOB 15301 EAST ILIFF AVE		DATE 8-25-86	SIGN INSTALLATION 3
LEGAL DESCRIPTION LOT 3		BLOCK 1	ADDITION SAGE EAST
OWNER NAME MOORE & COMPANY		ADDRESS 390 GRAND ST., DENVER, CO	
CONTRACTOR	NAME SUTTON SIGN COMPANY		LICENSE NO. A0 4881
	ADDRESS 16000 WEST 5TH AVE, GREEN, CO 80401		PHONE 753-6080
	SUPERVISOR FOR THIS JOB NAME CHRIS SMITH		ADDRESS 4225 E. MANitou PARK DENVER 753-6080
ELECTRICAL CONTRACTOR NAME ADDRESS			
SEPARATE PERMIT REQUIRED FOR ELECTRICAL SIGNS			
WHEN SIGNED AND VALIDATED BY BUILDING INSPECTION DEPARTMENT THIS PERMIT AUTHORIZES THE WORK DESCRIBED BELOW.			
CLASS OF WORK: NEW <input checked="" type="checkbox"/> ADDITION <input type="checkbox"/> ALTERATION <input type="checkbox"/> REPAIR <input type="checkbox"/> WRECK <input type="checkbox"/>			
APPLICANT TO COMPLETE DATA BELOW - PLOT PLAN & ELEVATION TO BE ATTACHED			
TYPE OF SIGN		FEATURES OF PROPOSED SIGN	
GROUND SIGN <input type="checkbox"/>		WILL BE ILLUMINATED <input checked="" type="checkbox"/>	
ROOF SIGN <input type="checkbox"/>		IF YES, IS LIGHT SOURCE CONCEALED <input checked="" type="checkbox"/>	
WALL SIGN <input checked="" type="checkbox"/>		U L NUMBER	
PROJECTING SIGN <input type="checkbox"/>		NUMBER OF FACES ON SIGN ONE	
COMBINATION SIGN <input type="checkbox"/>		TOTAL AREA OF SIGN, ALL SIDES 30.59 SQ. FT.	
OTHER <input type="checkbox"/>		TOTAL HEIGHT OF SIGN 3 FEET	
		PROJECTING OVER PUBLIC PROPERTY FEET	
		00 12-16-80 MAY	
REMARKS: SIGN B		EXISTING SIGNS	
		NUMBER OF EXISTING SIGNS 0	
		TOTAL SQ. FOOTAGE OF EXISTING SIGNS 039.59	
		BUILDING FRONTAGE 100 FEET SOUTH WEST	
		STREET FRONTAGE FEET COMM	
		AGENCY	AUTH. BY DATE
		ZONING	Q 8/25/86
		TRAFFIC ENGINEERING	
		VALUATION OF WORK \$	2980.
		PERMIT FEE	\$ 12.00
		TAX PAID	\$ 62.58
		TOTAL	\$ 74.58
		BUILDING INSPECTION	
		APPROVED BY	Q 8/25/86
		PERMIT AND RECEIPT NO.	286-332
		THIS FORM IS ADVERTISED ONLY WHEN VALIDATED HERE	
CITY SALES AND USE TAX 3%			
50% OF ESTIMATED VALUE OF MATERIALS AND LABOR			
ESTIMATED VALUE X 50% X 3%			
NOTE: ALL PURCHASING RECORDS AND INVOICES WILL BE RETAINED FOR A PERIOD OF THREE YEARS.			
NOTES TO APPLICANT:			
FOR INSPECTIONS OR INFORMATION CALL 695-7420			
FOR ALL WORK DONE UNDER THIS PERMIT THE PERMITTEE ACCEPTS FULL RESPONSIBILITY FOR COMPLIANCE WITH THE AURORA CODE.			
INSPECTION MUST BE CALLED UPON COMPLETION OF INSTALLATION.			
ALL RIGHTS AND PRIVILEGES REQUIRED UNDER THE PROVISIONS OF THE CITY SIGN REGULATIONS WHICH PERTAIN TO SIGN PROJECTING OVER PUBLIC PROPERTY ARE HERE LICENSES REVOCABLE AT ANY TIME BY THE CITY COUNCIL.			
* PAYABLE IF WORK IS STARTED BEFORE PERMIT IS REQUESTED.			
SIGNATURE OF APPLICANT		Sutton	

Jana Ottinson 3-5-87



Jana Ottenson 3-5-87

CITY OF AURORA BUILDING INSPECTION DIVISION PLOT PLAN

ADDRESS 15301 EAST ILIFF AVE

LEGAL
DESCRIPTION

LOT 3

BLK 1

ADDITION

SIDE EAST

NOTE:

INDICATE THE FOLLOWING INFORMATION - STREETS, ALLEYS AND/OR EASEMENTS; FRONT, REAR AND SIDE YARD SETBACKS; DIMENSIONS BETWEEN BUILDINGS AND DIMENSIONS OF BUILDINGS.

INDICATE EXISTING STRUCTURES WITH BROKEN LINE ----- PROPOSED STRUCTURES BY SOLID LINE

SIGN B

GRAPH SQUARES ARE 5' X 5' OR 1" = 20'



INDICATE NORTH IN CIRCLE

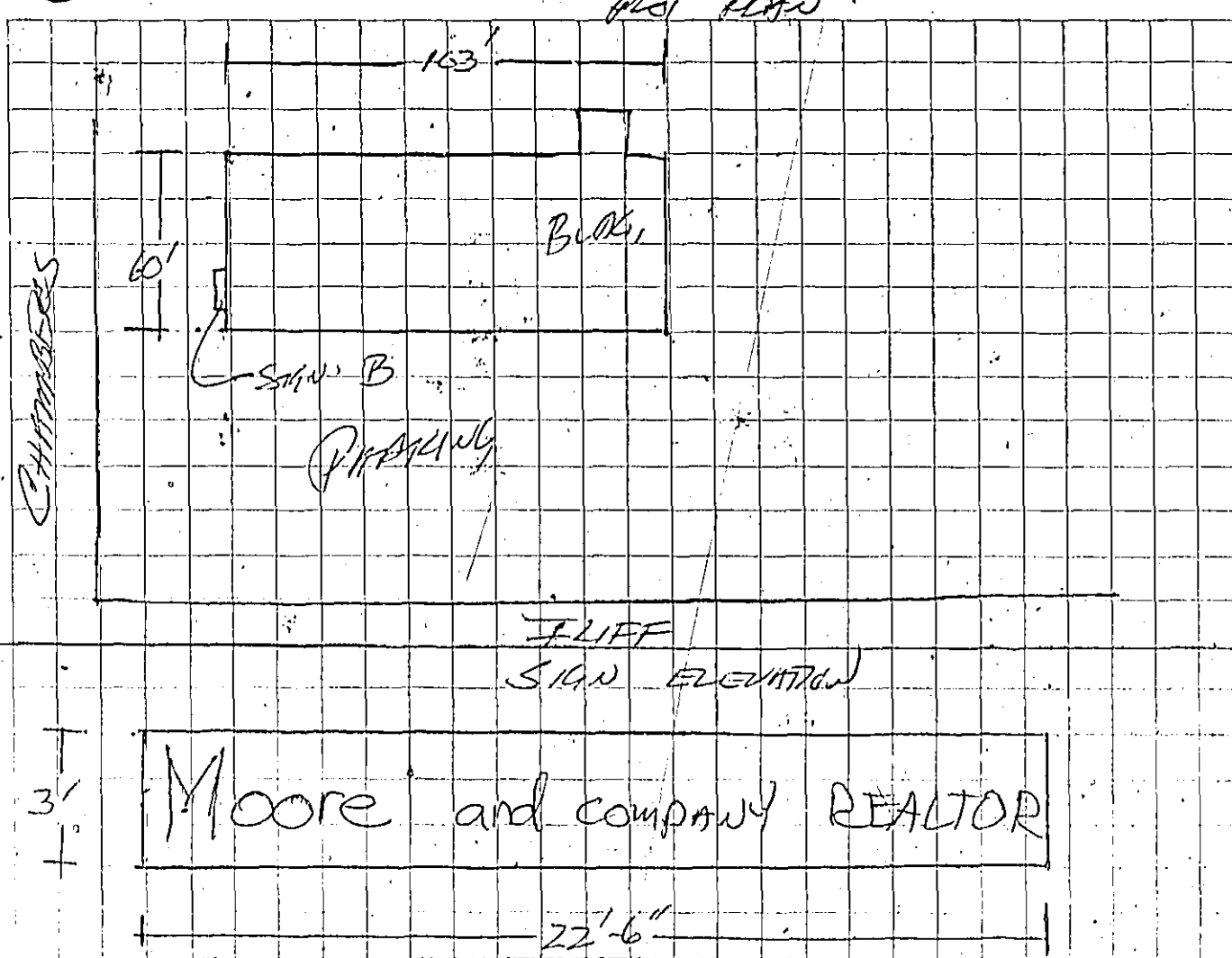

I/We certify that no use will be operated on the land or in the structure (s) identified above except the use (s) set forth above unless a new certificate of occupancy is obtained, the uses will be operated in compliance with the regulations, contained in the zoning chapter of the revised municipal code.

Name(s) of Owner(s) of Site & Structure(s) (Print)

DO NOT WRITE BELOW THIS LINE

Signature of Owner(s) or Authorized Representative

DISTRICT

COMM

APPROVED
AS NOTED

[Signature]

DATE

8/25/86

Jana Ottinson 3-5-87

3

CITY OF AURORA BUILDING INSPECTION DIVISION

BUILDING PERMIT

ADDRESS OF JOB: 15301 EAST FLIFF AVE DATE: 8-25-86 SIGN INSTALLATION: 3

LEGAL DESCRIPTION

LOT 3

BLOCK 1

ADDITION SAME EAST

OWNER

NAME: MOORE & COMPANY ADDRESS: 390 GRANT ST. DEN

CONTRACTOR

NAME: SUMMIT SIGN CO. LICENSE NO. AO 4881

ADDRESS: 1600 WEST 5TH AVE, CO 80401 PHONE: 753-6080

SUPERVISOR FOR THIS JOB: NAME: CHAS SMITH, 4275 E. TREXCO, CO 753-6080

ELECTRICAL CONTRACTOR NAME

ADDRESS

SEPARATE PERMIT REQUIRED FOR ELECTRICAL SIGNS

WHEN SIGNED AND VALIDATED BY BUILDING INSPECTION DEPARTMENT THIS PERMIT AUTHORIZES THE WORK DESCRIBED BELOW.

CLASS OF WORK: NEW ☒ ADDITION ☐ ALTERATION ☐ REPAIR ☐ WRECK ☐

APPLICANT TO COMPLETE DATA BELOW - PLOT PLAN & ELEVATION TO BE ATTACHED

TYPE OF SIGN

FEATURES OF PROPOSED SIGN

YES NO
☐ ☒
☐ ☐

EXISTING SIGNS

GROUND SIGN ☐

ROOF SIGN ☐

WALL SIGN ☒

PROJECTING SIGN ☐

COMBINATION SIGN ☐

OTHER ☐

WILL BE ILLUMINATED
IF YES, IS LIGHT SOURCE CONCEALED
U L NUMBER
NUMBER OF FACES ON SIGN ONE
TOTAL AREA OF SIGN, ALL SIDES 187 SQ. FT.
TOTAL HEIGHT OF SIGN 3 FEET
PROJECTING OVER PUBLIC PROPERTY 0 FEET
ok 12-11-88 MA

NUMBER OF EXISTING SIGNS

TOTAL SQ. FOOTAGE OF EXISTING SIGNS 61.18

BUILDING FRONTAGE FEET

STREET FRONTAGE FEET 101.11

REMARKS: Sign C



AGENCY AUTH. BY DATE

ZONING AUTH. BY DATE 8/25/86

TRAFFIC ENGINEERING

VALUATION OF WORK \$ 300.-

PERMIT FEE

PLAN YES ☐ NO ☐

FILED YES ☐ NO ☐

PENALTY FEE \$ 4.00

TAX PAID \$ 6.30

TOTAL \$ 10.30

CITY SALES AND USE TAX 3%

50% OF ESTIMATED VALUE OF MATERIALS AND LABOR

ESTIMATED VALUE X 50% X 3%

NOTE: ALL PURCHASING RECORDS AND INVOICES WILL BE RETAINED FOR A PERIOD OF THREE YEARS.

NOTES TO APPLICANT:

FOR INSPECTIONS OR INFORMATION CALL 695-7420

FOR ALL WORK DONE UNDER THIS PERMIT THE PERMITTEE ACCEPTS FULL RESPONSIBILITY FOR COMPLIANCE WITH THE AURORA CODE.

INSPECTION MUST BE CALLED UPON COMPLETION OF INSTALLATION.

ALL RIGHTS AND PRIVILEGES REQUIRED UNDER THE PROVISIONS OF THE CITY SIGN REGULATIONS WHICH PERTAIN TO SIGN PROJECTING OVER PUBLIC PROPERTY ARE MERE LICENSES REVOCABLE AT ANY TIME BY THE CITY COUNCIL.

* PAYABLE IF WORK IS STARTED BEFORE PERMIT IS REQUESTED.

SIGNATURE OF APPLICANT

[Signature]

APPROVED BY: [Signature] DATE: 8/25/86

PERMIT AND RECEIPT NO

286-333

THIS FORM IS A PERMIT ONLY WHEN VALUE WORK HERE

Jana Otterson 3-5-87

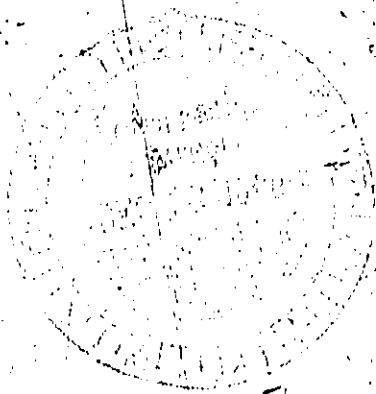

1

SEALED

POSTAGE

PAID

1.00

1.00

1.00

1.00

1.00

1.00

1.00

1.00

1.00

1.00

1.00

1.00

1.00

1.00

1.00

1.00

1.00

1.00

1.00

1.00

1.00

Jana Ottenson 3-5-87

CITY OF AURORA BUILDING INSPECTION DIVISION PLOT PLAN

ADDRESS

15301 East ILIFF AVE

LEGAL

DESCRIPTION

LOT

3

BLK

1

ADDITION

SIDE EAST

NOTE:

INDICATE THE FOLLOWING INFORMATION - STREETS, ALLEYS AND/OR EASEMENTS; FRONT, REAR AND SIDE YARD SETBACKS; DIMENSIONS BETWEEN BUILDINGS AND DIMENSIONS OF BUILDINGS.

INDICATE EXISTING STRUCTURES WITH BROKEN LINE ----- PROPOSED STRUCTURES BY SOLID LINE

SKN C

GRAPH SQUARES ARE 5' X 5' OR 1" = 20'



INDICATE NORTH IN CIRCLE

PLOT PLAN

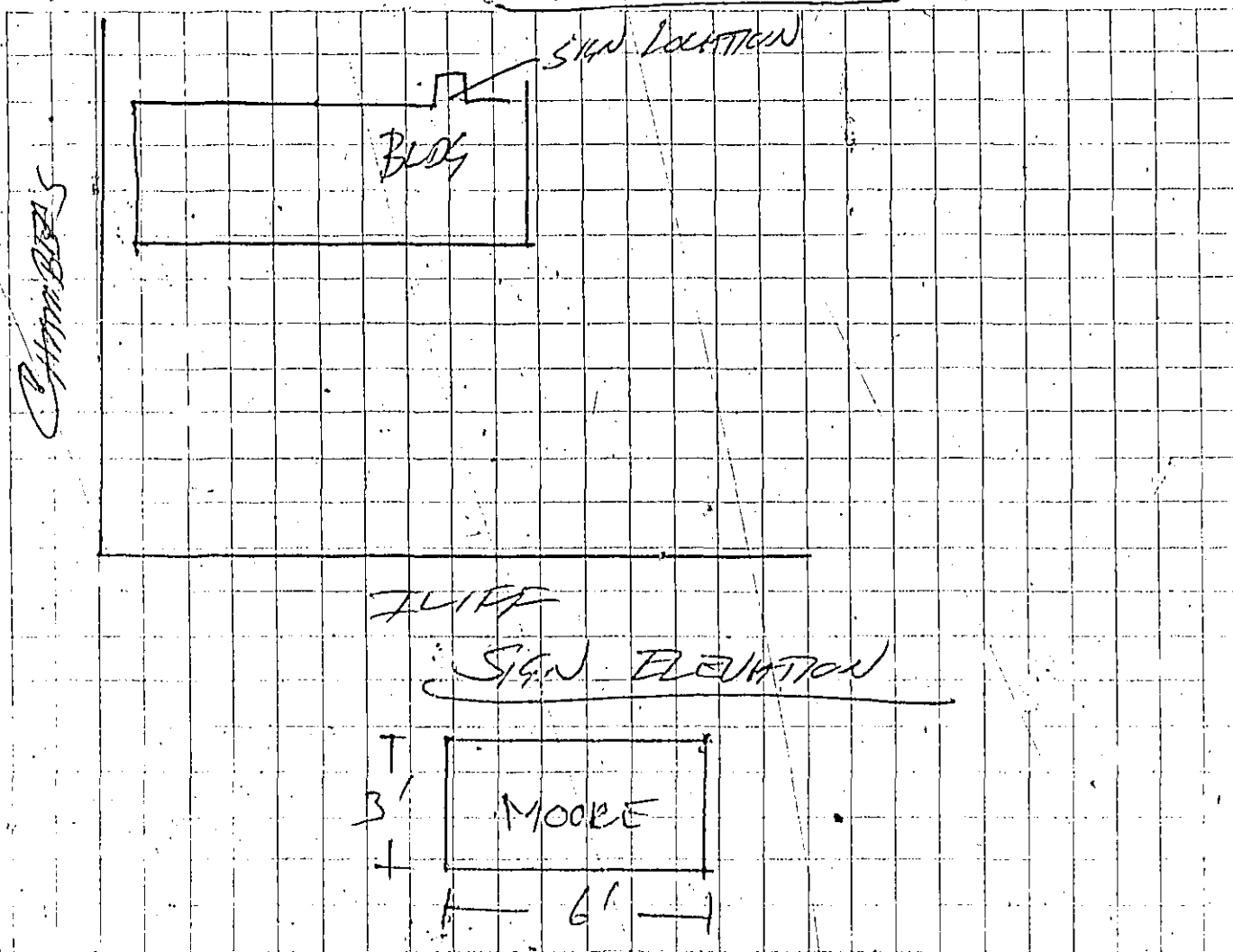

I/We certify that no use will be operated on the land or in the structure(s) identified above except the use(s) set forth above unless a new certificate of occupancy is obtained, the uses will be operated in compliance with the regulations, contained in the zoning chapter of the revised municipal code.

Name(s) of Owner(s) of Site & Structure(s) (Print)

DO NOT WRITE BELOW THIS LINE

Signature of Owner(s) or Authorized Representative

DISTRICT

CO 111

APPROVED
AS NOTED

[Signature]

DATE

8/25/86

3

1984

Shell

CITY OF AURORA BUILDING INSPECTION

BUILDING PERMIT

ADDRESS OF JOB <u>15301 E. 111TH AVE</u> <u>2200 S. CHAMBERLAIN</u>	DATE <u>7-12-84</u>	SIGN INSTALLATION <u>3</u>
LEGAL DESCRIPTION LOT <u>3</u> BLOCK <u>1</u> ADDITION <u>STATE EAST SUB DIVISION ELLIOTT #1</u>		
OWNER NAME <u>STATE EAST LTD.</u> ADDRESS <u>390 GRANT ST., DEER</u>		
CONTRACTOR	NAME <u>LITE CRAFT NEON INC.</u> LICENSE NO. <u>A08765</u>	
	ADDRESS <u>4571 W. 114TH, BLOOMINGDALE, IL 60022</u> PHONE <u>442-1124</u>	
	SUPERVISOR FOR THIS JOB NAME <u>CHARLES L. SMITH</u> SIGNATURE <u>[Signature]</u>	
ELECTRICAL CONTRACTOR NAME ADDRESS		
SEPARATE PERMIT REQUIRED FOR ELECTRICAL SIGNS		
WHEN SIGNED AND VALIDATED BY BUILDING INSPECTION DEPARTMENT THIS PERMIT AUTHORIZES THE WORK DESCRIBED BELOW.		
CLASS OF WORK: NEW <input checked="" type="checkbox"/> ADDITION <input type="checkbox"/> ALTERATION <input type="checkbox"/> REPAIR <input type="checkbox"/> WRECK <input type="checkbox"/>		
APPLICANT TO COMPLETE DATA BELOW - PLOT PLAN & ELEVATION TO BE ATTACHED		
TYPE OF SIGN GROUND SIGN <input checked="" type="checkbox"/> ROOF SIGN <input type="checkbox"/> WALL SIGN <input type="checkbox"/> PROJECTING SIGN <input type="checkbox"/> COMBINATION SIGN <input type="checkbox"/> OTHER <input type="checkbox"/>	FEATURES OF PROPOSED SIGN WILL BE ILLUMINATED <input checked="" type="checkbox"/> IF YES, IS LIGHT SOURCE CONCEALED <input checked="" type="checkbox"/> U L NUMBER _____ NUMBER OF FACES ON SIGN <u>1</u> TOTAL AREA OF SIGN, ALL SIDES <u>80</u> SQ. FT. <u>114</u> TOTAL HEIGHT OF SIGN <u>6</u> FEET <u>440</u> PROJECTING OVER PUBLIC PROPERTY <u>0</u> FEET <u>114002</u>	EXISTING SIGNS NUMBER OF EXISTING SIGNS <u>0</u> TOTAL SQ. FOOTAGE OF EXISTING SIGNS <u>0</u> BUILDING FRONTAGE _____ FEET STREET FRONTAGE _____ FEET
REMARKS: <u>Sign #1 Meets Sq Footage ok by</u> <u>Jim Walston. would not require a amendment on</u> <u>the change</u>		
CITY SALES AND USE TAX 3%		
50% OF ESTIMATED VALUE OF MATERIALS AND LABOR ESTIMATED VALUE <u>3000</u> X 50% <u>1500</u> X 3% <u>45.00</u>		
NOTE: ALL PURCHASING RECORDS AND INVOICES WILL BE RETAINED FOR A PERIOD OF THREE YEARS.		
NOTES TO APPLICANT: FOR INSPECTIONS OR INFORMATION CALL 695-7420 FOR ALL WORK DONE UNDER THIS PERMIT THE PERMITTEE ACCEPTS FULL RESPONSIBILITY FOR COMPLIANCE WITH THE AURORA CODE. INSPECTION MUST BE CALLED UPON COMPLETION OF INSTALLATION. ALL RIGHTS AND PRIVILEGES REQUIRED UNDER THE PROVISIONS OF THE CITY SIGN REGULATIONS WHICH PERTAIN TO SIGN PROJECTING OVER PUBLIC PROPERTY ARE HERE LICENSES REVOCABLE AT ANY TIME BY THE CITY COUNCIL. • PAYABLE IF WORK IS STARTED BEFORE PERMIT IS REQUESTED.		
SIGNATURE OF APPLICANT <u>[Signature]</u>		
APPROVED BY <u>[Signature]</u> DATE <u>7-20-84</u>		
PERMIT AND RECEIPT NO. <u>45086</u>		
THIS FORM IS A PERMIT ONLY WHEN VALIDATED HERE		
ARCHIVIST FEB 12 3 30 AM '85		

3-4-81

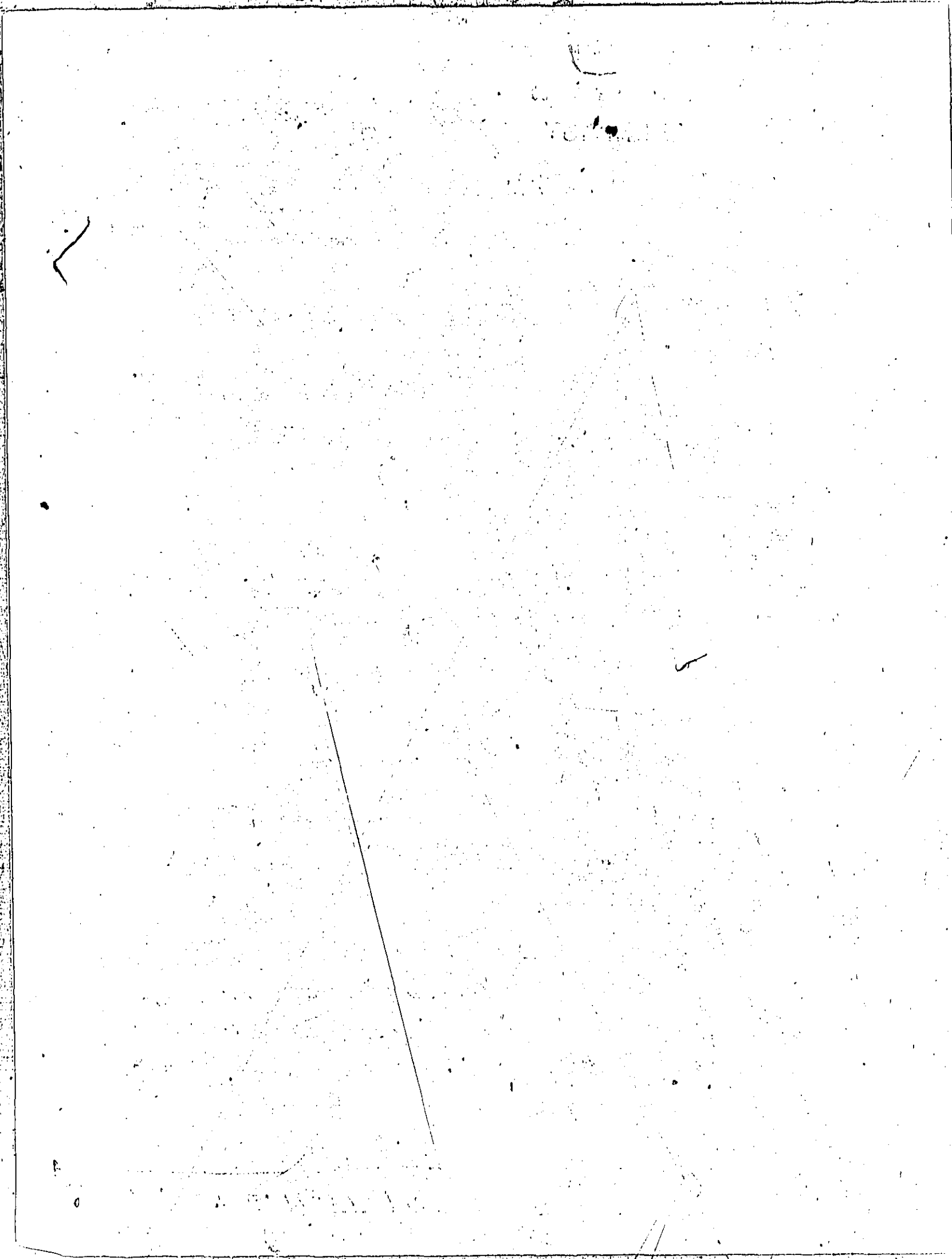

CITY OF AURORA BUILDING INSPECTION DIVISION PLOT PLAN

ADDRESS 15801 E. 16th AVE
 LEGAL DESCRIPTION LOT #3 BLK 1 ADDITION SUBDIVISION
FILE #1

NOTE: INDICATE THE FOLLOWING INFORMATION - STREETS, ALLEYS AND/OR EASEMENTS; FRONT, REAR AND SIDE YARD SETBACKS; DIMENSIONS BETWEEN BUILDINGS AND DIMENSIONS OF BUILDINGS.
 INDICATE EXISTING STRUCTURES WITH BROKEN LINE ----- PROPOSED STRUCTURES BY SOLID LINE _____

GRAPH SQUARES ARE 5' X 5' OR 1" = 20'



INDICATE NORTH IN CIRCLE

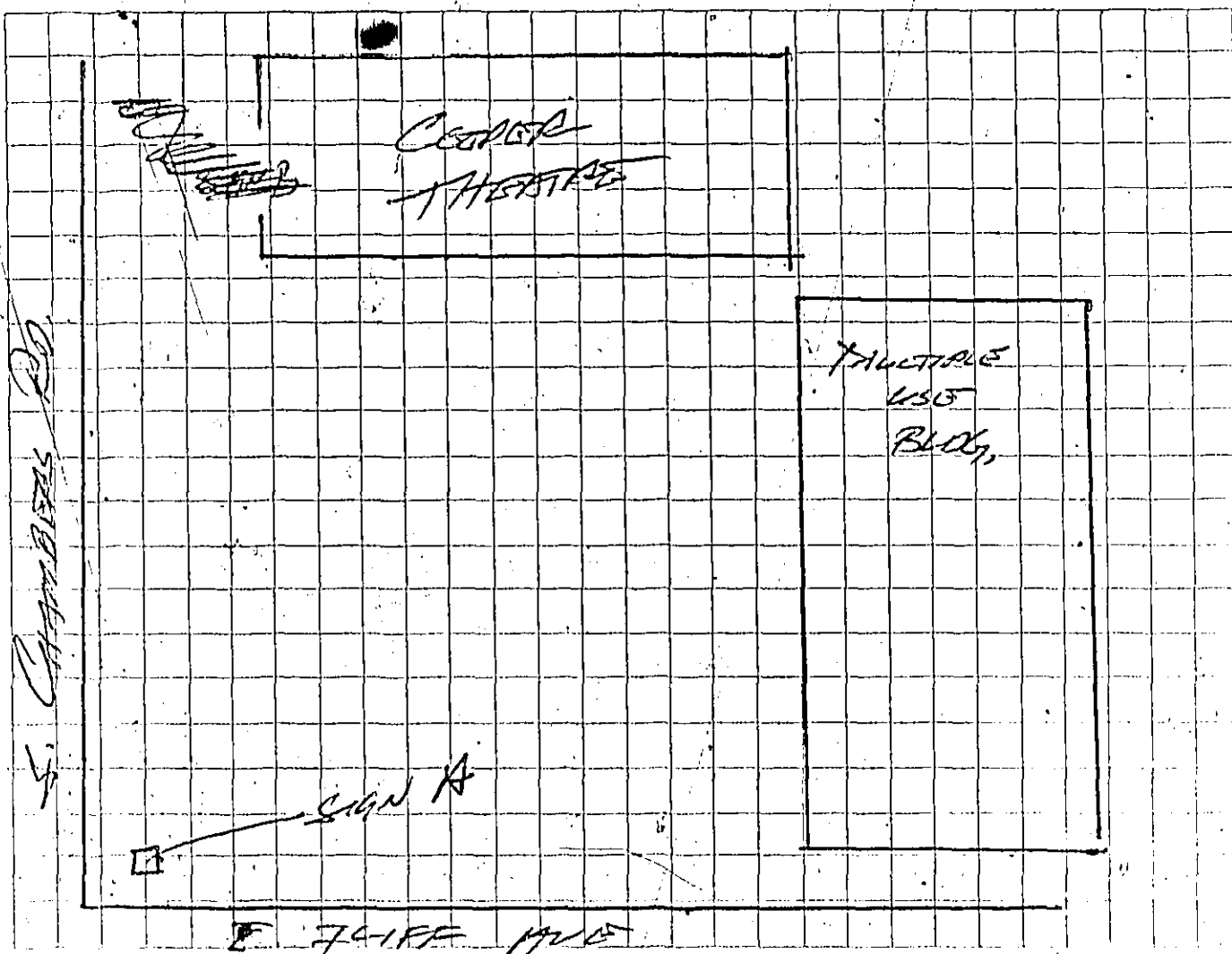

I/We certify that no use will be operated on the land or in the structure (s) identified above except the use (s) set forth above unless a new certificate of occupancy is obtained, the uses will be operated in compliance with the regulations, contained in the zoning chapter of the revised municipal code.

SUBDIVISION

Name(s) of Owner(s) of Site & Structure(s) (Print)

Charles K. Smith

Signature of Owner(s) or Authorized Representative

DO NOT WRITE BELOW THIS LINE

DISTRICT Comm

APPROVED
AS NOTED

BS

DATE 7/12/14

FORM 620-B

INSPECTOR'S COPY

Laure Davila 12/4

CITY OF AURORA
MUNICIPAL RECORDS

JAN 13 2000

BUILDING PERMIT RECEIPT

Permit Number: 899-13094

Date: 12/23/99

Address of Job: 15301 E ILIFF AVE

Contractor: CHARLES TAYLOR COMMUNICAT

License #1 A17634

Description of work: CELL SITE

CELL SITE PLAN LOC 1-9-D INCLS ERECT

NO CO REQD

Construction Type:	_____	Permit Fee:	<u>317.00</u>
Occupancy Group:	<u>U-2</u>	Improvement Fee:	<u>0.00</u>
CO Required:	<u>F</u>	Tax Paid:	<u>656.25</u>
Taxable Amount:	<u>17500</u>	Planfee:	<u>238.00</u>
Contract Price:	<u>35000</u>	Total:	<u>1211.25</u>

Notes to Applicant:

For inspections call 739-7416 one day in advance. For information call 739-7420
ALL Inspection Requests must be called in by 4 P.M. The Previous Day
The PERMITEE accepts FULL responsibility for all work done under this permit.
ALL work must be done in accordance with ALL applicable building codes

THIS FORM BECOMES A VALID PERMIT WHEN IT IS VALIDATED HERE

PAID
1999 DEC 22 AM 10:55
CITY OF AURORA
COLORADO

Approved By: _____



SIGNATURE OF APPLICANT

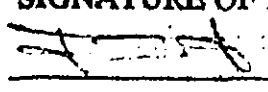

Lance Davison 4/4

City of Aurora, Colorado

Address:

15301 E. Tiff Ave

Permit Number:

B99-13094

Lot:

Block:

Subdivision:

Type of Construction:

Type of Occupancy:

THE GENERAL AND FOLLOWING SUB CONTRACTORS ARE REQUIRED TO BE LICENSED

TYPE OF CONTRACTOR

NAME

LICENSE NO.

General

Concrete

Mason

Roofing

Lathing/Gypsum Board

HVAC

Electrical (State number)

Plumbing

Fire Protection

WATER METER NO.

TAP FEE

ROUGH INSPECTIONS MUST SHOW ON PLUMBING, ELECTRICAL & HVAC BEFORE FRAME INSPECTION

COMMENTS

FINAL

Ground Iron

● Rough Plumbing

Final Plumbing

● Rough Electrical

Electrical Service

Final Electrical

Gas Pipe

● Rough HVAC

Final HVAC

Footings

Calsson

Engineer's Letter

Concrete Reinforcing

Engineer's Letter

Foundation Waterproofing

Roof/Pie Roof

● Rough Frame

Insulation

Lath/Gypboard

Final Frame

Life Safety: SPRINKLER SYSTEM :

FIRE ALARM :

FIRE EXTINGUISHER :

EXIT LIGHTS :

Engineering

Grade

Zoning

FOR INSPECTIONS CALL 739-7420 ONE DAY IN ADVANCE BEFORE 4:00 PM

CITY OF AURORA BUILDING PERMIT & PLOT PLAN APPROVAL

Address of Job		15301 East Tiff Ave Aurora, CO 80013			Date	11/24/99	
Legal Description		Lot 003 Block 001 Subdivision			Sege East Sub F/g 1		
PROPOSED USE OF STRUCTURE <u>Rooftop Antennas for Cell Site</u>							
CLASS OF WORK:							
AREA AT GRADE (SF)	GARAGE SINGLE DOUBLE	NO. OF STORIES	TOTAL UNITS	OCCUPANCY GROUP & DIV	USE ZONE		
TOT. BLDG. (SF)	BASEMENT FIN. UNFIN.	HEIGHT (FEET)	<u>GAUC</u>	TYPE NOT CONSTRUCTED	<u>L-2</u>	SITE PLAN	<u>84</u>
CONTACT PERSON: <u>Nicole Crosby</u>				DEPT/DIV		AUTHORIZED BY	
PHONE NUMBER: <u>(303) 398-8444</u>				ZONING ✓		<u>NMC</u>	
 <p>NOTE: Indicate the following information - streets, alleys, and/or easement front, rear and side yard setbacks; dimensions between buildings and dimensions of buildings. Indicate existing structures with a solid line _____ Proposed structures with broken line _____</p>				ENGINEERING			
				TRAFFIC ✓		<u>At</u>	
				LIFE SAFETY			
				RIGHT OF WAY			
				WATER			
				WASTEWATER			
				FORESTRY			
				PLANNING			
				PLANS EXAM ✓		<u>[Signature]</u>	
				BUILDING			
REMARKS: <u>Site Plan attached</u> <u>Required from [unclear]</u> <u>Admnd attached</u>							

We certify that no use will be operated on the land or in the structure(s) identified above except the use(s) set forth above unless a new certificate of occupancy is obtained, the uses will be operated in compliance with the regulations contained in the Aurora City Code.

Name(s) of Owner(s) of Site & Structure(s) (Print)

Nicole A Crosby
Signature of Owner(s) or Authorized Representative

Lance Davala 4/4

CITY OF AURORA BUILDING PERMIT INFORMATION

PLEASE CHECK BOXES BY ITEMS WHICH APPLY TO JOB ON WHICH YOU ARE APPLYING FOR A PERMIT. IF A BOX IS CHECKED, PLEASE FILL OUT ANY BLANK SPACE ASSOCIATED WITH THE ITEM CHECKED. PLEASE COMPLETE ALL APPLICABLE SPACES ON THIS FORM AS IT WILL GREATLY AID IN OUR QUICK AND ACCURATE PROCESSING OF YOUR APPLICATION

Address of Job: 15301 E. TIFF AVE Contract Price: \$35,000

Contractor Name (or Homeowner): TRD - Nicole Crosby

Phone No: 308-398-8444

License No: A17634

Date: 11/24/99

DESCRIBE THE WORK YOU WILL BE DOING

- Rooftop Antennas for cell site

CO not REG'D only FINAL

Loc: 1-9-D

☐ HVAC ☐ PLUMBING ☒ ELECTRICAL ☐ LIFE SAFETY ☒ BUILDING

INDICATE BY (N) FOR NEW AND (E) FOR EXISTING FOR ALL ITEMS CHECKED BELOW

MECHANICAL

☐ A/C OR COOLER CFM/TON () ☐ GAS LOG BTU'S ()
☐ GAS PIPE SIZE-LENGTH () ☐ GAS FIREPLACE BTU'S ()
☐ HEATING TYPE BTU'S () ☐ HOOD TYPE/CFM ()

LIFE SAFETY

☐ FIRE SPRINKLER TYPE () ☐ FIRE ALARM POINTS ()
☐ HOOD SUPPRESSION TYPE () ☐ FIRE EXTINGUISHERS ()
☐ STORAGE TANKS SIZES () ☐ MEDICAL GAS ()

ELECTRICAL

☐ A/C OR COOLER ELEC. AMP () ☐ ELEC. SERV. CHG. AMP. ()
☐ ELECTRIC CIRCUIT #/AMP () ☐ CONSTRUCTION METER ()

PLUMBING

☐ SHOWER # () ☐ WATER CLOSET # ()
☐ WATER HEATER BTU'S () ☐ LAVATORY # ()
☐ URINAL # () ☐ KITCHEN SINK # ()
☐ BATHTUB # () ☐ SWIMMING POOL ()
☐ LAWN SPRINKLER HEADS # () ☐ FLOOR DRAIN # ()
☐ HOT TUB () ☐ MISCELLANEOUS ()

THIS SPACE FOR OFFICE USE ONLY

TAXABLE AMOUNT USE TAX AMOUNT 656.25 PERMIT AMOUNT 317.00 Pick 228.00

Total \$ 1,211.25

Luisa Davalos 4/4

Date Insp.: 01/06/2000 Permit Number: B99-13094 Address: ILIFF AVE E 15301
Type Insp.: EF Results: OK Inspector: GEHRING
Comments:
Correctons:

Date Insp.: 01/07/2000 Permit Number: B99-13094 Address: ILIFF AVE E 15301
Type Insp.: FF Results: NONE Inspector: HARDY
Comments:
Correctons:

Date Insp.: 01/10/2000 Permit Number: B99-13094 Address: ILIFF AVE E 15301
Type Insp.: FF Results: POSTED Inspector: GALLEGOS
Comments:
Correctons: NO PERMIT CARD OR CITY APPROVED PLANS

Date Insp.: 01/11/2000 Permit Number: B99-13094 Address: ILIFF AVE E 15301
Type Insp.: FF Results: FINAL Inspector: DOLL
Comments:
Correctons: